

# Fastalarms Caravan alarm fitting instructions © M Sheerin 2009

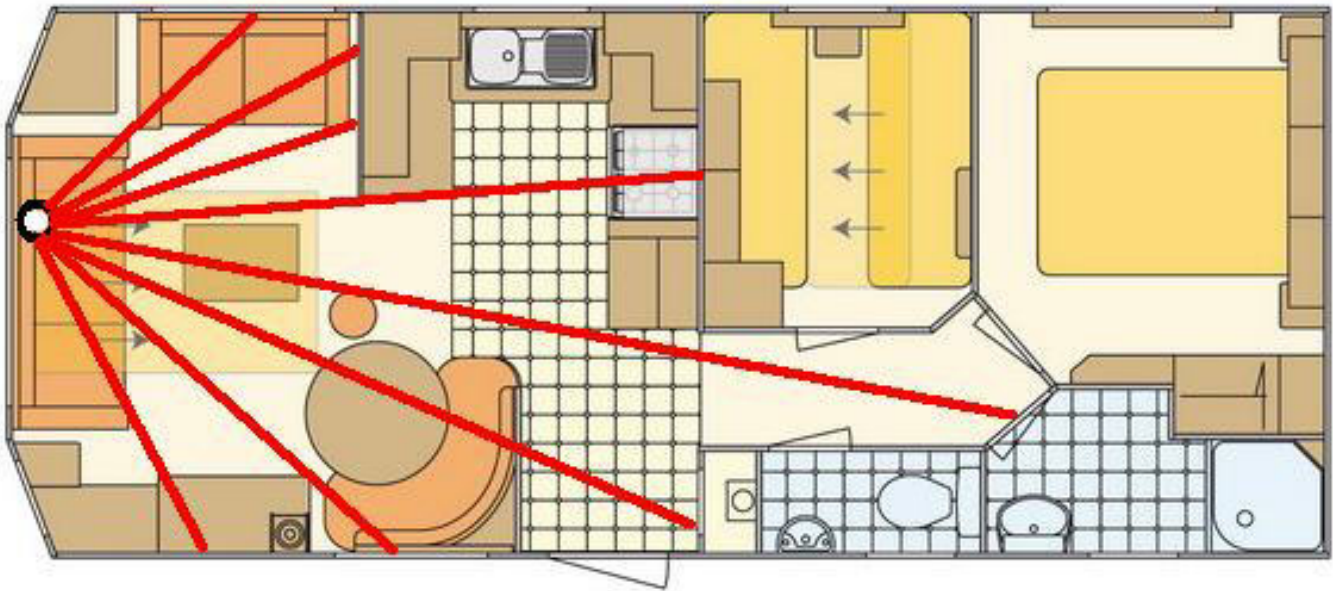

The first thing you need to do is decide where to fit the pir movement sensor.

With a caravan you have to be careful not to face the sensor directly toward windows or direct or reflected sunlight.

You need to position the sensor so it covers as much interior area as possible including the door into the caravan. Notice the sensor is slightly offset to the centre of the caravan and not in the corner of the room as in a traditional home position. This is because the kitchen partition would hide most of the kitchen area if the sensor was placed top right and the entrance door would be shielded if the sensor was placed in the bottom left. The red lines show the area the sensor can 'see' in its current position.

It is important to remember that caravans are not made in the same rigid way as a house and that the walls are much thinner and more fragile.

Do not use wall plugs to fasten the pir to the wall.

Position the sensor as high as possible but leave 3cm from the ceiling to enable the sensor front to be clipped in place.

Using a 1.5mm drill bit make two pilot holes to match the knockouts you have removed. Because you are not fixing into a corner the rear wall fixing dropouts are preferable.

If you decide the knockouts you have used are wrong and decide to use the others you must tape up the unused ones to prevent false alarms from small insect access.

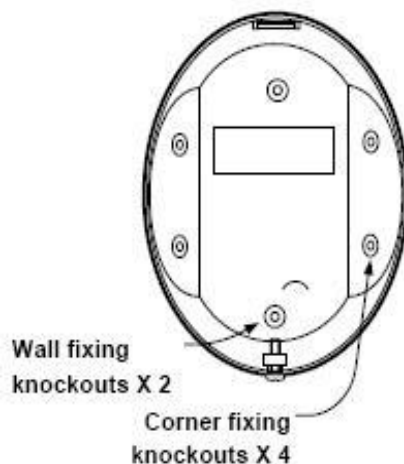

Use the small screws provided but make sure you don't overtighten them and spoil the holes. If you do you may have to use heavy duty exterior double sided sticky pads to hold the sensor in place instead. ( not supplied ) When the backplate is fixed and the sensor front has been clipped on and screwed into place press the white learn button on the sensor to ensure The red led flashes. If it doesn't remove the sensor front and check battery placement.

Cont....

Next you need to site the siren.

You need to find a place on your caravan where your siren can do two things

1. Be visible
2. Be out of reach as much as possible. Obviously unlike a house it cannot be mounted high up but it doesn't want to be easily reached either. The alarm features flashing LEDs when activated so a line of site to other campers or residents must be considered.

IF FITTING TO A TOURING CARAVAN ensure the alarm is securely fastened for travel using bigger screws if necessary



Fitting.

1. Remove cover retaining screw
- 2..Remove LEFT hand cover plate

Now fasten the backplate to the exterior wall. Use a 1.5mm drill to make pilot holes and then use the long screws provided. Ensure the backplate is securely fixed or the tamper switch will activate false alarms when the cover is fitted. Again take care not to strip the holes by overtightening. When the backplate is in place you can then turn on the siren using the on/off switch. ( ensure the tamper switch is not over a recess or gap)

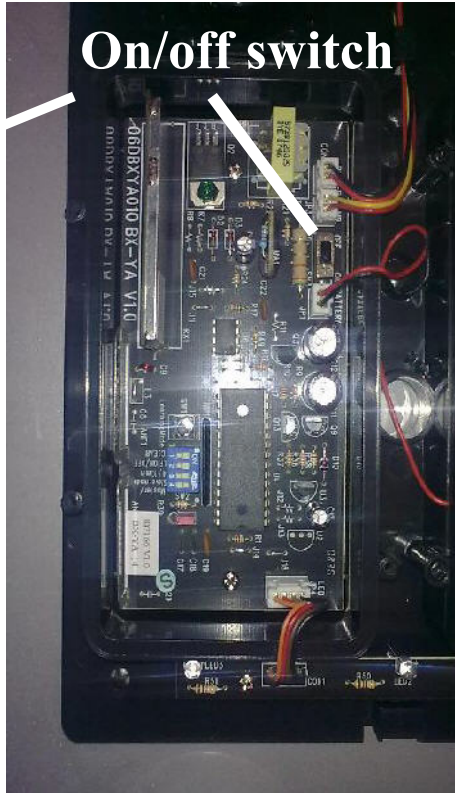

**WARNING!** When you switch the Siren on it will bleep and the red Leds will flash. The siren will then immediately sound. This will cause surprise and can damage your hearing **HAVE THE KEYFOB READY** before you switch on the siren and press the disarm button to silence the siren when It has sounded.

Now replace the cover and fasten the retaining screw being careful not to activate the tamper switch. If you do the siren will sound again. use the keyfob disarm button to silence it.



### Using the system

To arm the system press the Arming button till the red led lights on the keyfob. You will hear a single beep and the siren lights will flash. The system will full set in 20 seconds.

To disarm press the disarm button until the keyfob led lights. You will hear two beeps and the siren lights will flash

Take care not to accidentally arm the system with the fob in your pocket etc. **DO NOT LOSE THE KEYFOB**

When armed and the 20 seconds exit time has elapsed the system will trigger immediately the sensor detects movement so it is wise to Disarm the alarm **BEFORE** entering your property.

To activate the alarm deliberately press the Panic Button for 3 seconds. To stop the alarm press the Disarm button. Your batteries will last For 2 - 6 years dependent on usage.